

- KEYED NOTES (DEMOLITION):**
- 1 DEMOLISH ALL EXISTING SANITARY SEWER AND VENT PIPING WITHIN BLOCK AREA. PROVIDE ALL NECESSARY DEMOLITION OF EXISTING PIPING TO ACCOMMODATE SPACE FOR NEW WASTE AND VENT PIPING. COORDINATE DEMOLITION WITH NEW PIPING LAYOUT. CAP AND SEAL REMAINING UNUSED PIPE TAKE-OFF WATER AND AIR TIGHT.
 - 2 EXISTING VENT PIPING SHALL BE DEMOLISHED.
 - 3 EXISTING WATER HEATER AND ALL ASSOCIATED PIPING AND ACCESSORIES SHALL REMAIN.
 - 4 EXISTING WASTE PIPING SHALL REMAIN.
 - 5 EXISTING SUMP PUMP ASSEMBLY SHALL REMAIN.
 - 6 EXISTING SUMP PUMP DISCHARGE PIPE SHALL REMAIN.
 - 7 EXISTING FIXTURE WASTE BRANCH LINE SHALL BE DEMOLISHED. CAP BRANCH WASTE TAP LINE WATER AND AIR TIGHT.
 - 8 EXISTING VENT LINE SHALL BE DEMOLISHED. CAP BRANCH VENT LINE WATER AND AIR TIGHT.
 - 9 ALL EXISTING SANITARY SEWER AND VENT PIPING WITHIN BLOCK AREA SHALL REMAIN.
 - 10 EXISTING WASTE PIPING SHALL BE DEMOLISHED.
 - 11 CAP EXISTING SANITARY SEWER BRANCH PIPE WATER AND AIR TIGHT.

GENERAL DEMOLITION NOTE:
 -ALL REMOVED EQUIPMENT AND MATERIALS SHALL BE DISPOSED OF IN ACCORDANCE WITH PREVAILING REGULATIONS AND LAWS AT CONTRACTOR'S EXPENSE.

CONTRACTOR'S DEMOLITION NOTE

1. THE INFORMATION CONTAINED IN THESE DEMOLITION DOCUMENTS IS NOT TO BE CONSIDERED AS COMPLETE AND FULLY ACCURATE AS PERTAINS TO THE EXACT QUANTITY AND LOCATION OF ALL SYSTEM COMPONENTS. THE INFORMATION CONTAINED HEREIN WAS OBTAINED FROM ORIGINAL DESIGN DOCUMENTS AND LIMITED SITE VISITS. IT SHALL BE THE CONTRACTOR'S RESPONSIBILITY TO FIELD VERIFY THE EXACT LOCATION, SERVICE, AND QUANTITY OF ALL EXISTING SYSTEM COMPONENTS PRIOR TO BEGINNING DEMOLITION WORK. THE INFORMATION CONTAINED HEREIN IS TO BE USED SOLELY AS AN AID TO THE SUB-CONTRACTOR IN COMPLETING THE CONTRACT. ADDITIONAL INFORMATION CONCERNING EXISTING ITEMS TO BE REUSED CAN BE FOUND ON DOCUMENTS CONTAINING NEW WORK.
2. ALL EQUIPMENT, PIPING, AND ACCESSORIES SERVING THIS FACILITY THAT ARE SHOWN ON THIS PLAN SHALL BE LOCATED AND VERIFIED FOR USAGE PRIOR TO DEMOLITION.

**BUILDING 560 ENLARGED
 FIRST FLOOR PLAN - WASTE & VENT DEMOLITION - AREA A**

8' 4' 0' 8'
 SCALE: 1/8" = 1'-0"

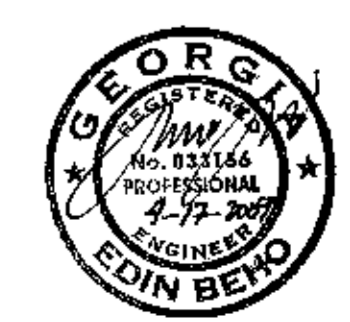
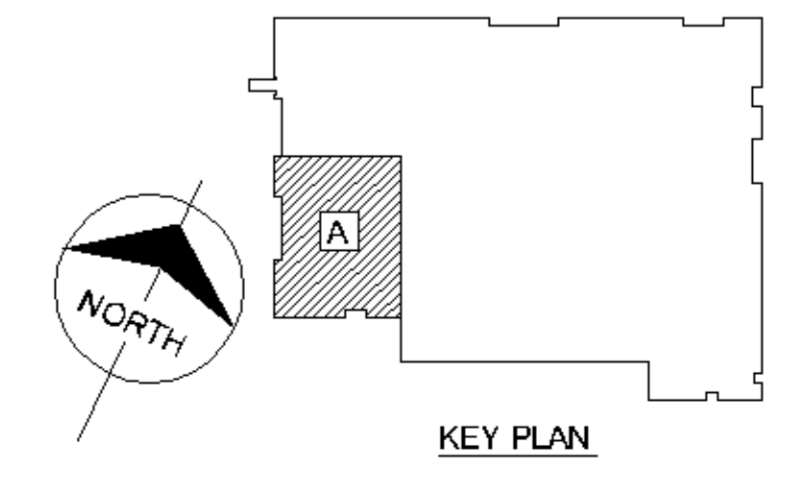

REV	DESCRIPTION	DATE	APP.

File Name: NET1407.dwg	Plot Scale: AS SHOWN
Plot Date: APR 17, 2009	WIP20K-09-R-0017
DESIGN BY: E. BEHO	DRAWN BY: C. COOPER
REVIEWED BY: J. BERGER	DATE:

U.S. ARMY ENGINEER DISTRICT
 CORPS OF ENGINEERS
 SAVANNAH, GEORGIA

BURNS & MCDONNELL
 9400 WARD PARKWAY
 KANSAS CITY, MISSOURI

RELOCATE 14TH ASOS FACILITIES (8560), PIPE AFB, NORTH CAROLINA

BUILDING 560
 ENLARGED FIRST FLOOR PLAN
 WASTE & VENT PIPING DEMOLITION - AREA A